



Retroset Pay

Shut-off Smart Payment Set

A component of the ChoiceConnect Pay Solution, Retroset Pay offers Smart Payment capabilities for C&I applications. Built upon a robust shut-off valve, Restroset Pay allows utilities to ensure revenue collection.

FEATURES

- » Automatic valve shut-off
- » All-in one solution
- » Outdoor protected
- » Multi-range coverage (G10, G16)
- » 2-way communication through Smart Card

THE SYSTEM

Retroset Pay is a cabinet that includes a pressure regulator, a C&I meter equipped with a communication module and a Smart Card based shut-off valve.

Smart Payment has always been limited to residential applications. With Retroset Pay, Itron extends Smart Payment capabilities to the C&I segment, typically used for the smaller customers such as restaurants or large houses.

OPERATING MODE

Initially, the customer will have to load a given quantity of gas to the Retroset Pay with his smart card.

Every 100L of gas consumed, the Cyble equipped meter will transmit its pulse to the electronic valve through the Cyble sensor module.

The loaded amount will then decrease according to the consumption.

When the total loaded volume is exhausted, the valve will close, the customer shall recharge his smart card at the point of sales and reload the valve in order to safely re-open and use the gas.

SOLUTION ARCHITETURE



STANDARDS & COMPLIANCE

Refer to individual components.

For the Valve itself:

- » CE
- » ATEX (Ex II3G Ex ic IIA T5 Gc)

DATA LOGGING & CONFIGURATION

- » **Data Logging:** The set has a built-in data logging function that stores the last 13 months of consumption in addition to the last 3 insertion timestamps.
- » **No Disconnect:** The meter can be configured to avoid disconnection during specified periods. This can include defined times of day, certain days, weekends, or specific periods of the year.
- » **Self Decommissioning:** An automatic "close down" special action lets the utility or consumer decommission the account directly. No on-site visit from the utility is required.

BILLING METHODS

Itron's Smart Payment solution allows **automated data collection** at the time the consumer is topping up its energy credit. In accordance with the local regulations, the meter can be set in different billing modes:

- » **Regular Prepayment:**
By loading the Smart Card upfront, the consumer has to pay his gas provision before consuming.
- » **Pay-as-you-go:**
In this typical post payment mode, the end customer is charged for the consumed gas after a certain period based on volume or time.

SAFETY AND SECURITY

- » Metrological and functional parts of the meter protected with separate seals.
- » **Leak detection:** A leak test is conducted every time the gas valve opens to ensure other gas appliances have not been left on. The valve automatically closes if the installation is not tight.
- » **Alarms (valve closes automatically):**
 - Open cover alarm
 - Overflow alarm
 - Low battery alarm
- » **Secure Payflex Smart Card token**

Technical specifications (valve only)

Capacity	G10, G16 (G25, G40 on demand)
Casing	Aluminium (with Stainless Steel Pivot)
Electronics Housing	ABS + Polycarbonate
Dimensions	Overall size: 240 mm x 118 mm x 192 mm
Humidity Max	93% RH at 40°C
Operating Temperature	-25°C to +55°C
Storage Temperature	-25°C to +70°C
Dust and Rain	IP54 protection
Maximum Operating Pressure	1 bar
Pressure Drop	Under 2 mbar
Battery	12 years average life time
Electronics	ATEX (Ex II3G Ex ic IIA T5 Gc)
Display	LCD

Dimensions and Weight (valve only)

A	B	C	D	Weight
240 mm	118 mm	192 mm	DN50	3,480 kg

Refer to individual brochures for other components

Dimensions, weight and connection threads depending on components.

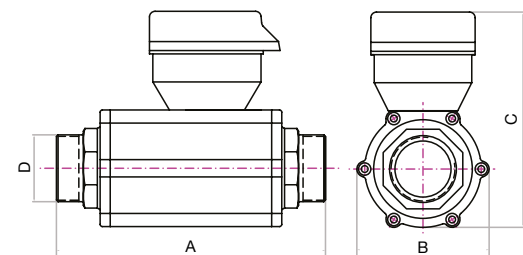

Join us in creating a more **resourceful world**.
To learn more visit **itron.com**

While Itron strives to make the content of its marketing materials as timely and accurate as possible, Itron makes no claims, promises, or guarantees about the accuracy, completeness, or adequacy of, and expressly disclaims liability for errors and omissions in, such materials. No warranty of any kind, implied, expressed, or statutory, including but not limited to the warranties of non-infringement of third party rights, title, merchantability, and fitness for a particular purpose, is given with respect to the content of these marketing materials. © Copyright 2016 Itron. All rights reserved. **GA-RETROSETPAY-01-EN-02-16**

ITRON GMBH

Hardeckstraße 2
D-76185 Karlsruhe
Germany

Tel: +49 721 5981-0
Fax: +49 721 5981-189